

KSM 水密门报警系统 KSM Watertight door alarm system

设备组成 Device Composition

序号 S/N	型号 Model	名称 Name	主要材质 Main material	重量 Weight	防护等级 IP class
1	KSM-1ZQ	水密门报警器 Watertight door alarm	铝/碳钢 Aluminium/Carbon steel	1.5Kg	IP20
2	KSM-1FG	水密门复示器 Watertight door repeater	铝/碳钢 Aluminium/Carbon steel	1.7Kg	IP44
3	KSM-1FQ	水密门复示器 Watertight door repeater	铝/碳钢 Aluminium/Carbon steel	1.5Kg	IP20
4	KSM-1D	电源单元(采集箱) Power unit(acquisition box)	碳钢 Carbon steel	8Kg	IP22
5	KSM-1DG	电源单元(采集箱) Power unit(acquisition box)	碳钢 Carbon steel	15Kg	IP22
6	KSM-1H	转换盒 Conversion box	不锈钢 Stainless steel	2.3Kg	IP56
7	KSM-1L	指示灯 Indication light	阻燃PC Fire retardant PC	1.0Kg	IP68
8	KSM-1J	接近开关 Proximity switch	不锈钢 Stainless steel	1.0Kg	IP68
9	BBJ-14-□□	防爆状态警示灯 Explosion-proof alarm light	不锈钢 Stainless steel	8.5Kg	IP68

KSM-1ZQ水密门报警器 Watertight door alarm

功能描述

指示水密门状态的系统，采用微处理器技术，可指示水密门完全关闭、完全打开、关闭/开启过程、故障四种状态。

Function

Watertight door status indication system introduces microprocessor technology, which can indicate four status of watertight door such as fully close, fully open, close/open process and fault .

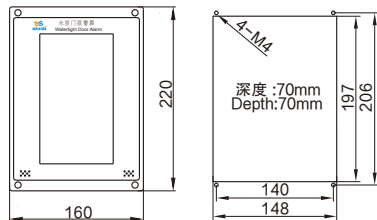

开孔尺寸 Hole dimension

电源Power supply:DC24V $\begin{matrix} +30\% \\ -25\% \end{matrix}$
报警声压级Sound pressure level: 75dB ~ 85dB
颜色Color: 黑色black(RAL9005)
防护等级 IP class:IP20
重量 Weight:1.5Kg

KSM-1FG KSM-1FQ 水密门复示器 Watertight door repeater



KSM-1FG

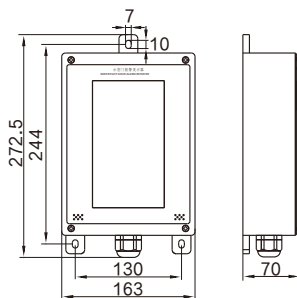

KSM-1FG

电源Power supply:DC24V $\begin{matrix} +30\% \\ -25\% \end{matrix}$
报警声压级Sound pressure level: 75dB ~ 85dB
颜色Color: 黑色black(RAL9005)
防护等级 IP class:IP44
重量 Weight:1.7Kg

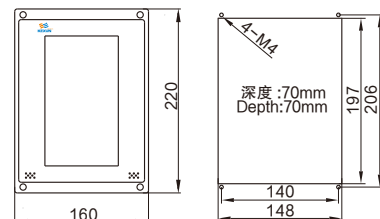

开孔尺寸 Hole dimension

KSM-1FQ

电源Power supply:DC24V $\begin{matrix} +30\% \\ -25\% \end{matrix}$
报警声压级Sound pressure level: 75dB ~ 85dB
颜色Color: 黑色black(RAL9005)
防护等级 IP class:IP20
重量 Weight:1.5Kg

KSM-1D 电源单元(采集箱) Power unit(acquisition box)

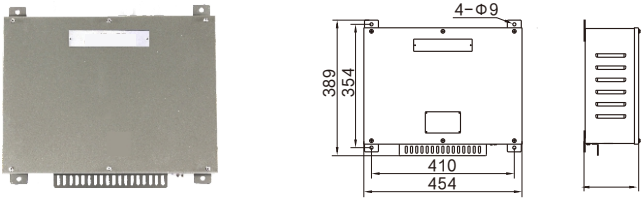

输入电压 Input voltage: AC220V ± 10%
DC24V ^{+30%}/_{-25%}

输出电压 Output voltage: DC24V

输出功率 Output power: 150W

颜色 Color: 浅灰色 Light gray (RAL 7035)

防护等级 IP class: IP22

重量 Weight: 8Kg

最多可接入12路水密门
Maximum access to 12 watertight doors

KSM-1DG 电源单元(采集箱) Power unit(acquisition box)

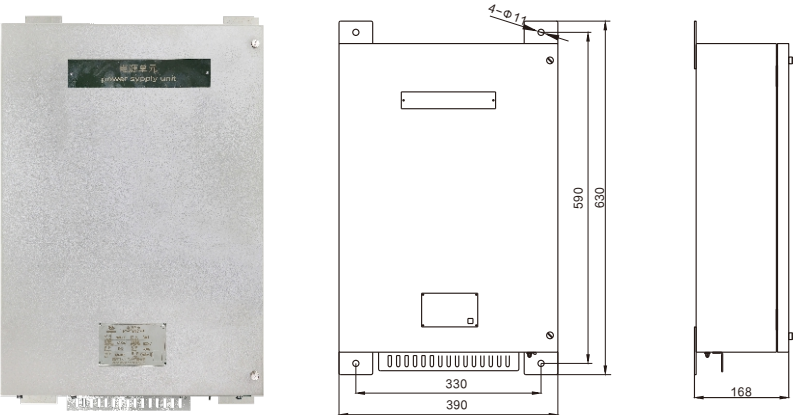

输入电压 Input voltage: AC220V ± 10%
DC24V ^{+30%}/_{-25%}

输出电压 Output voltage: DC24V

输出功率 Output power: 480W

颜色 Color: 浅灰色 Light gray (RAL 7035)

防护等级 IP class: IP22

重量 Weight: 15Kg

最多可接入36路水密门
Maximum access to 36 watertight doors

KSM-1H转换盒 Conversion box

功能描述

将水密门的状态转换成控制器规定的信号形式，并送到控制器供其读取。

Function

It will convert the status of watertight door to the required signal by the controller and send to the controller for its reading.

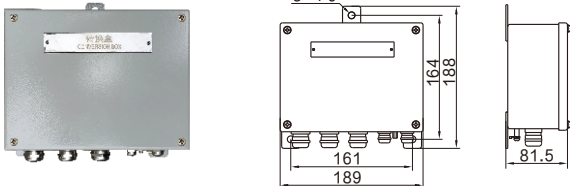

电源 Power supply: DC24V ^{+30%}/_{-25%}

颜色 Color: 浅灰色 Light gray (RAL 7035)

防护等级 IP class: IP56

重量 Weight: 2.3Kg

填料函进线孔径 Stuffing box cable entrance hole size: 3-φ12mm, 2-φ6mm

KSM-1J接近开关 Proximity switch



电源 Power supply: DC24V ^{+30%}/_{-25%}

防护等级 IP class: IP68

重量 Weight: 1.0Kg

填料函进线孔径 Stuffing box cable entrance hole size: φ5mm

随机电缆 random cable: 20m

开关距离小于35mm
Switch distance less than 35mm

KSM-1L指示灯 Indication light

功能描述

安装在水密门边，指示水密门的状态。

Function

It is mounted near watertight door to indicate the status of watertight door.

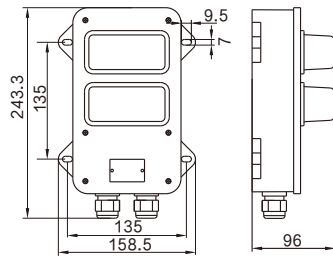

电源 Main power supply: DC24V $\begin{matrix} +30\% \\ -25\% \end{matrix}$
 颜色 Color: 中绿灰 green gray (RAL 6034)
 防护等级 IP class: IP68
 重量 Weight: 1.0Kg
 填料函进线孔径 Stuffing box cable entrance hole size: 2- Φ 14mm

BBJ-14-□□ 防爆状态警示灯 Explosion-proof status warning light

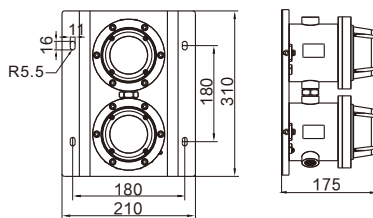

BBJ-14-□□型
 螺纹 thread
 电压 Power supply

电压 Power supply:
 A: AC230V
 B: AC110V
 C: DC24V
 螺纹 thread: M25、M20、M22

防护等级 IP class: IP68
 重量 Weight: 8.5Kg
 填料函尺寸 Stuffing box size: M25 × 1.5
 防爆等级 Explosion-proof class: Ex db opis II C T6 Gb

水密门报警系统接线示意图

Watertight door alarm system connection diagram

